

U-305
SUPERFICIES

M2 INTERIORES: 69.18 M2
M2 EXTERIORES: 9.15 M2
M2 TOTALES: 78.33 M2

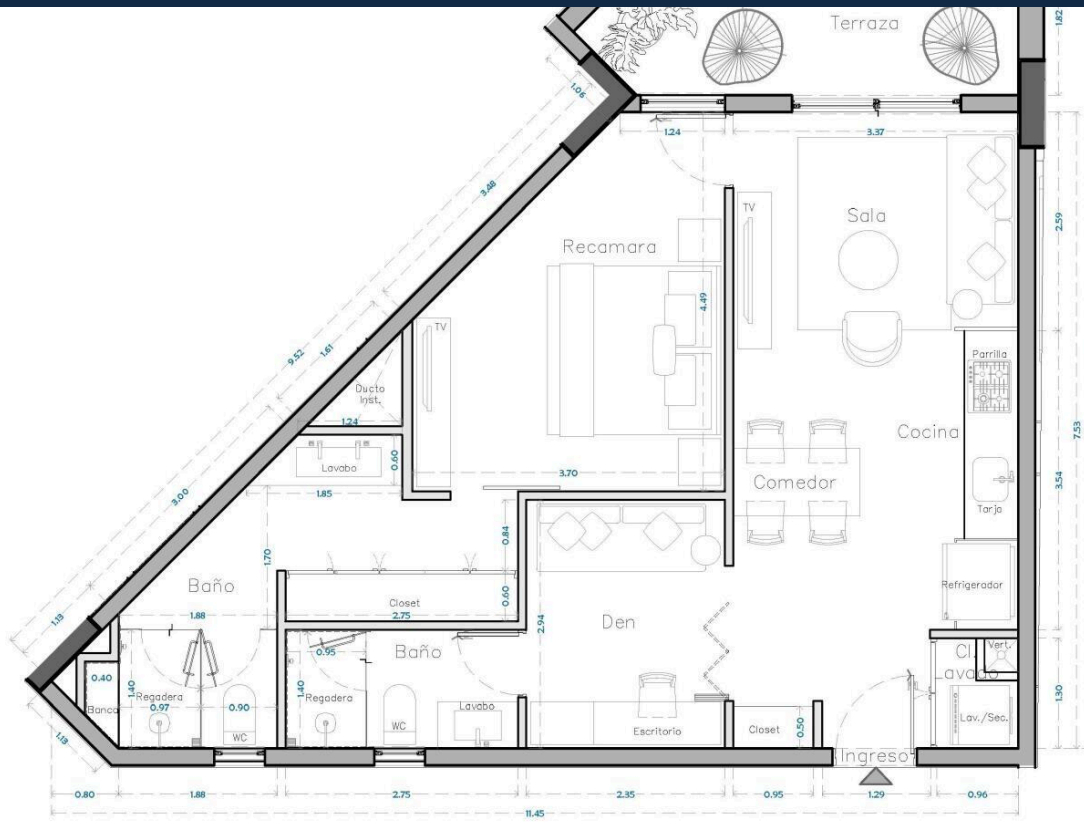

ESCALA:

South Bay 305

\$534,036.00 USD

South Bay | 65 # Units in Develop | Emiliano Zapata
Centro South, Puerto Vallarta
MLS ID: 39383

General Information

Total m2:	78	Total M2 const:	78.33
Total SqFt:	842.83	Walls:	Concrete,Sheetrock
Price/Sq Meter:	6,817.77	Total Bedrooms:	1
Total Baths:	2	Full baths:	2
Floor Number:	Nivel 03	Primary View:	Ocean
Secondary View:	Mountain	Furnished:	Unfurnished
Pet Friendly:	Yes	Parking:	Parking on Property
Location:	City		

Features & Amenities

Common Amenities

24 Hours Security:	<input checked="" type="checkbox"/>	Elevator:	<input checked="" type="checkbox"/>
Fire Pit:	<input checked="" type="checkbox"/>	Garden:	<input checked="" type="checkbox"/>
Gym:	<input checked="" type="checkbox"/>	Intercom:	<input checked="" type="checkbox"/>
Jacuzzi:	<input checked="" type="checkbox"/>	Pool:	<input checked="" type="checkbox"/>

Appliances

Hood/Vent:	<input checked="" type="checkbox"/>	Refrigerator/Freezer:	<input checked="" type="checkbox"/>
Oven:	Electric	Cook Top:	Electric

Devices

Air Conditioning:	Mini-Split	Water Heater:	Electric
-------------------	------------	---------------	----------

Hoa Info

Hoa Name:		Dues per month (\$MX):	8,342.00
24-hr Security:	<input checked="" type="checkbox"/>	Building Insurance:	<input checked="" type="checkbox"/>
Common Area Electric:	<input checked="" type="checkbox"/>	Common Area Maintenance:	<input checked="" type="checkbox"/>
Garden Maintenance:	<input checked="" type="checkbox"/>	Gym:	<input checked="" type="checkbox"/>
On-Site Admin:	<input checked="" type="checkbox"/>	Pool Maintenance:	<input checked="" type="checkbox"/>

Especifications

Days On Market	89	Year Buit	2026
Pre-Construction	Yes	Est. Delivery Date	2027-02-10
Construction Manifest	No	Title	Escritura,Fideicomiso
Electricity	CFE	Water	City
Sewage	City	Road Type	Paved

MARINA VALLARTA

Paseo de la Marina 161 Las Palmas 1, local 2.
+ (52) 322 221 2377 | + (52) 322 221 0079

DOWNTOWN PUERTO VALLARTA

Pino Suarez 203, Colonia Emiliano Zapata.
+ (52) 322 222 2233

info@exoticrealty.com

REAL ESTATE

DEVELOPMENTS

VACATION RENTALS

PROPERTY MANAGEMENT

NEIGHBORHOODS

OUR COMPANY

FAQs

CONTACTO

