

**U-405**  
**SUPERFICIES**

M2 INTERIORES : 69.17 M2  
M2 EXTERIORES : 9.15 M2  
M2 TOTALES : 78.32 M2

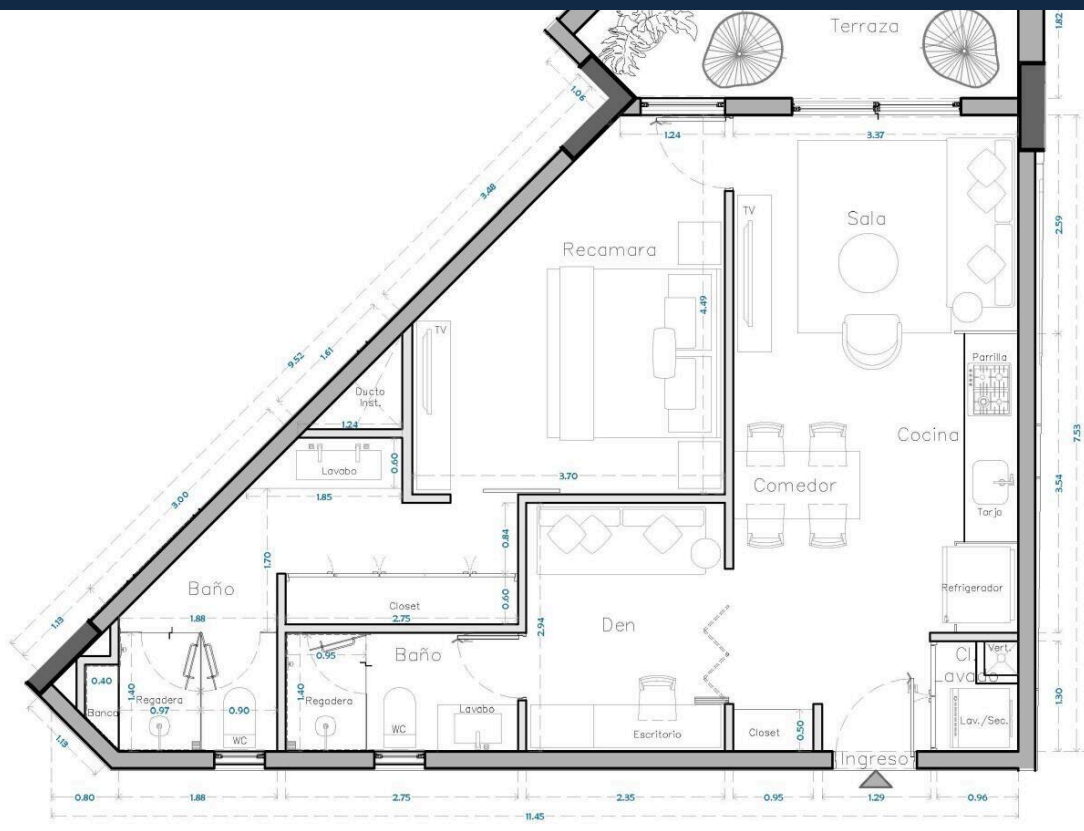

ESCALA:

**South Bay 405**

\$561,119.00 USD

South Bay | 65 # Units in Develop | Emiliano Zapata  
Centro South, Puerto Vallarta  
MLS ID: 39724

**General Information**

<b>Total m2:</b>	<b>78</b>	<b>Total M2 const:</b>	<b>78.32</b>
<b>Total SqFt:</b>	<b>842.72</b>	<b>Walls:</b>	<b>Concrete</b>
<b>Price/Sq Meter:</b>	<b>7,164.44</b>	<b>Total Bedrooms:</b>	<b>1</b>
<b>Total Baths:</b>	<b>2</b>	<b>Full baths:</b>	<b>2</b>
<b>Floor Number:</b>	<b>Nivel 04</b>	<b>Primary View:</b>	<b>Ocean</b>
<b>Secondary View:</b>	<b>Mountain</b>	<b>Furnished:</b>	<b>Unfurnished</b>
<b>Pet Friendly:</b>	<b>Yes</b>	<b>Parking:</b>	<b>Parking on Property</b>
<b>Location:</b>	<b>City</b>		

**Features & Amenities**

**Common Amenities**

<b>24 Hours Security:</b>	<input checked="" type="checkbox"/>	<b>Elevator:</b>	<input checked="" type="checkbox"/>
<b>Fire Pit:</b>	<input checked="" type="checkbox"/>	<b>Garden:</b>	<input checked="" type="checkbox"/>
<b>Gym:</b>	<input checked="" type="checkbox"/>	<b>Intercom:</b>	<input checked="" type="checkbox"/>
<b>Jacuzzi:</b>	<input checked="" type="checkbox"/>	<b>Pool:</b>	<input checked="" type="checkbox"/>

**Appliances**

<b>Hood/Vent:</b>	<input checked="" type="checkbox"/>	<b>Refrigerator/Freezer:</b>	<input checked="" type="checkbox"/>
<b>Oven:</b>	<b>Electric</b>	<b>Cook Top:</b>	<b>Electric</b>

**Devices**

<b>Water Heater:</b>	<b>Electric</b>
----------------------	-----------------

**Hoa Info**

<b>Hoa Name:</b>		<b>Dues per month (\$MX):</b>	<b>8,341.00</b>
<b>24-hr Security:</b>	<input checked="" type="checkbox"/>	<b>Building Insurance:</b>	<input checked="" type="checkbox"/>
<b>Common Area Electric:</b>	<input checked="" type="checkbox"/>	<b>Common Area Maintenance:</b>	<input checked="" type="checkbox"/>
<b>Garden Maintenance:</b>	<input checked="" type="checkbox"/>	<b>Gym:</b>	<input checked="" type="checkbox"/>
<b>On-Site Admin:</b>	<input checked="" type="checkbox"/>	<b>Pool Maintenance:</b>	<input checked="" type="checkbox"/>

**Especifications**

<b>Days On Market</b>	<b>89</b>	<b>Pre-Construction</b>	<b>Yes</b>
<b>Est. Delivery Date</b>	<b>2027-02-10</b>	<b>Title</b>	<b>Escritura,Fideicomiso</b>
<b>Electricity</b>	<b>CFE</b>	<b>Water</b>	<b>City</b>
<b>Sewage</b>	<b>City</b>	<b>Road Type</b>	<b>Paved</b>

**MARINA VALLARTA**

Paseo de la Marina 161 Las Palmas 1, local 2.  
+ (52) 322 221 2377 | + (52) 322 221 0079

**DOWNTOWN PUERTO VALLARTA**

Pino Suarez 203, Colonia Emiliano Zapata.  
+ (52) 322 222 2233

info@exoticrealty.com

REAL ESTATE

DEVELOPMENTS

VACATION RENTALS

PROPERTY MANAGEMENT

NEIGHBORHOODS

OUR COMPANY

FAQs

CONTACTO

